

Welcome to the East Area Planning Committee

- This planning committee meeting is held in public but it is not a public meeting.
- There will be an opportunity for the public to address the committee on each application.
- 45 If you wish to speak for or against a planning application, you need to have either requested it in advance, or hand in one of the available speaker forms, or speak to the clerk.
- Information on meeting protocol and conduct at the committee is set out in the Code of Practice.
- This is in the committee agenda just before the first planning application report.

Existing Site Plan

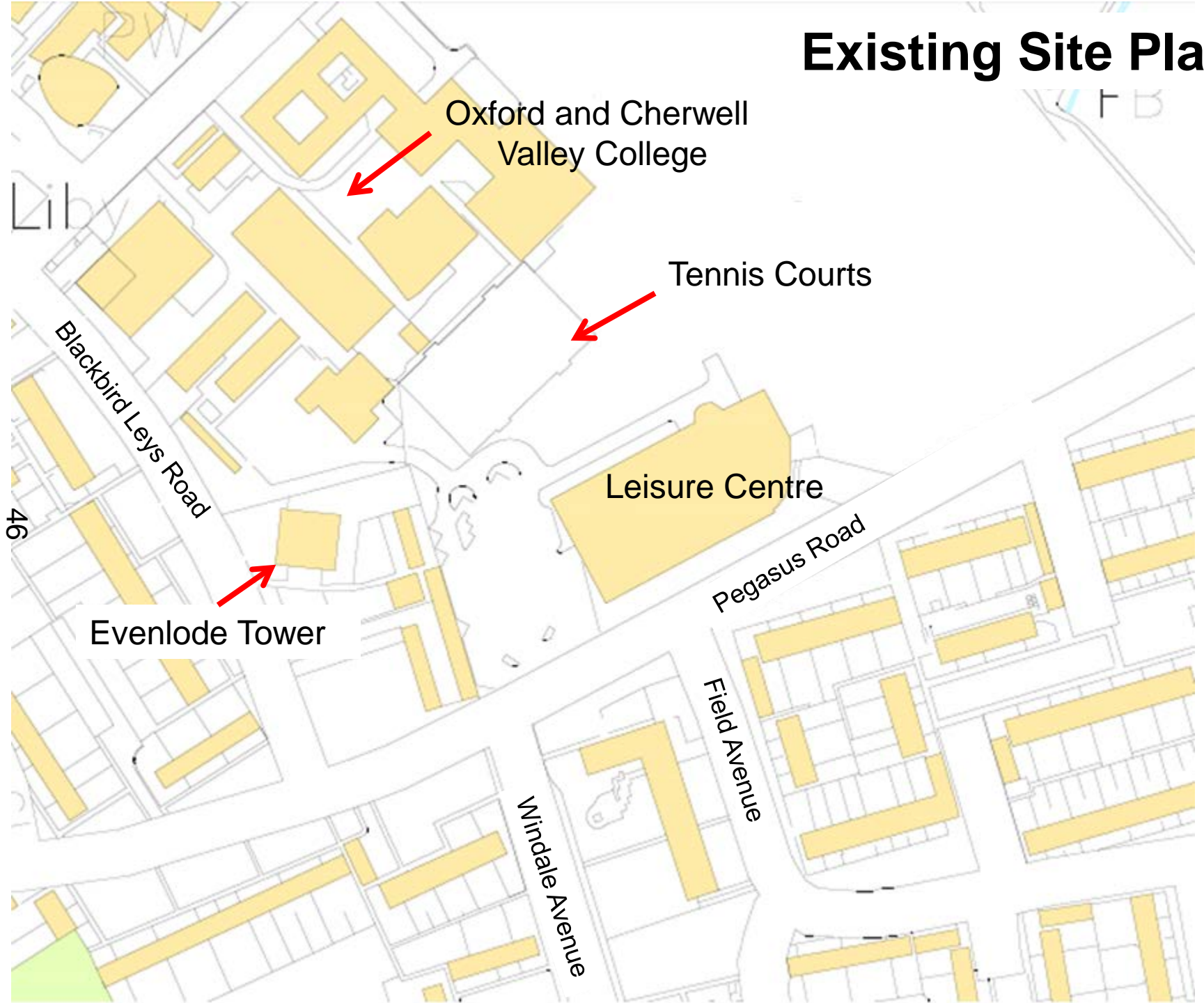

Oxford and Cherwell
Valley College

Tennis Courts

Leisure Centre

Evenlode Tower

Blackbird Leys Road

Pegasus Road

Field Avenue

Windle Avenue

46

Lib

FB

Location Plan

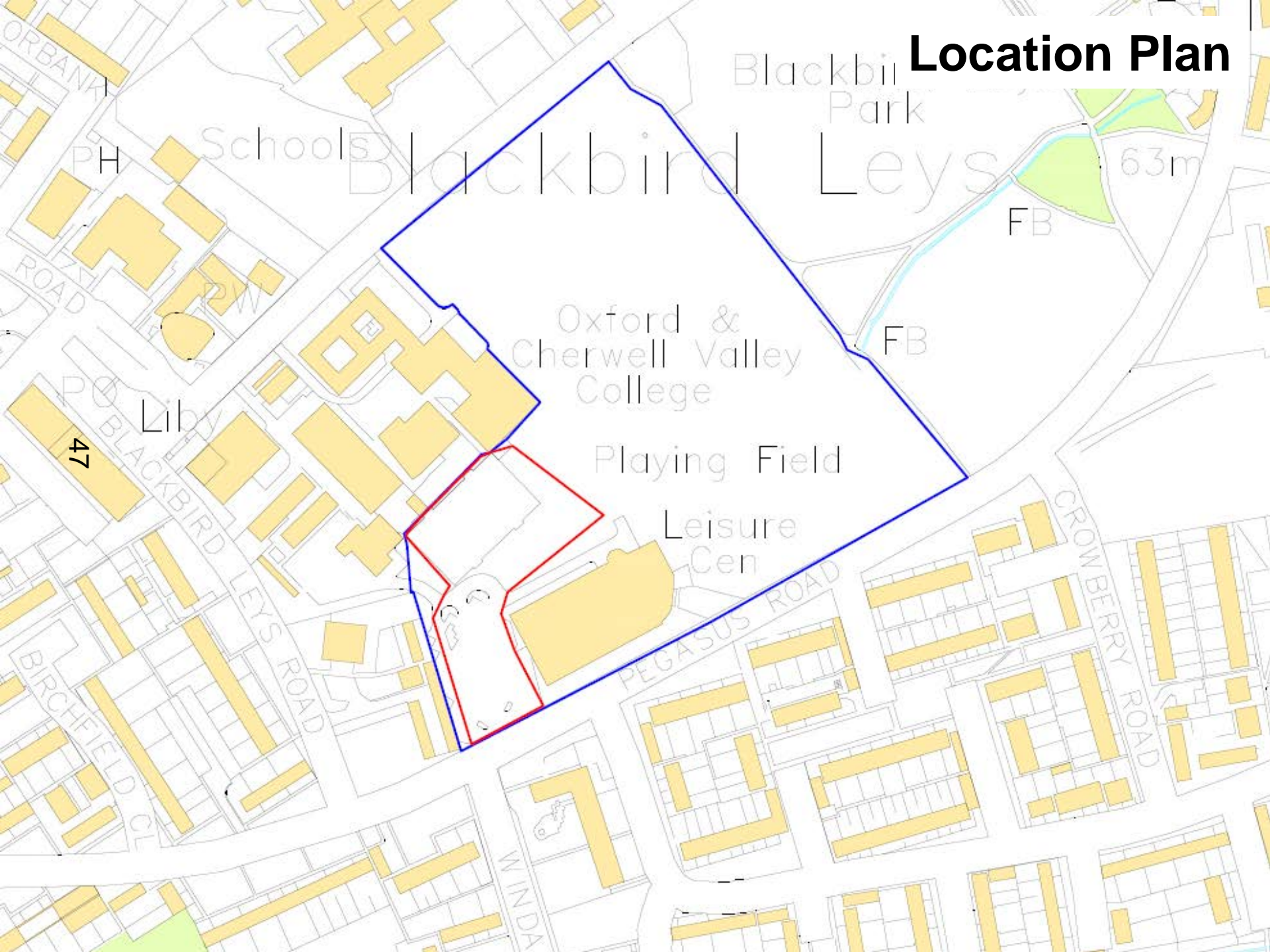

48

ONE

PARKING



49



50



51

PLANNING APPLICATION

Advertisement of the existing natural amenity space and the proposed development for the site, which is a residential development of 10 dwellings, is shown on the site plan attached to the application. The site is located at the rear of the existing residential development and is currently used as a garden. The proposed development will be a residential development of 10 dwellings, which will be a mix of 2, 3 and 4 bedroom houses. The site is currently used as a garden and is surrounded by trees and shrubs. The proposed development will be a residential development of 10 dwellings, which will be a mix of 2, 3 and 4 bedroom houses. The site is currently used as a garden and is surrounded by trees and shrubs.

Neighbourhood Planning Area

Neighbourhood Planning Area: [Name of Area]

Application Number: [Number]

Submitted on: [Date]

For further information, please contact the Planning Department on [Phone Number].

10th July 2016



Proposed Site Plan

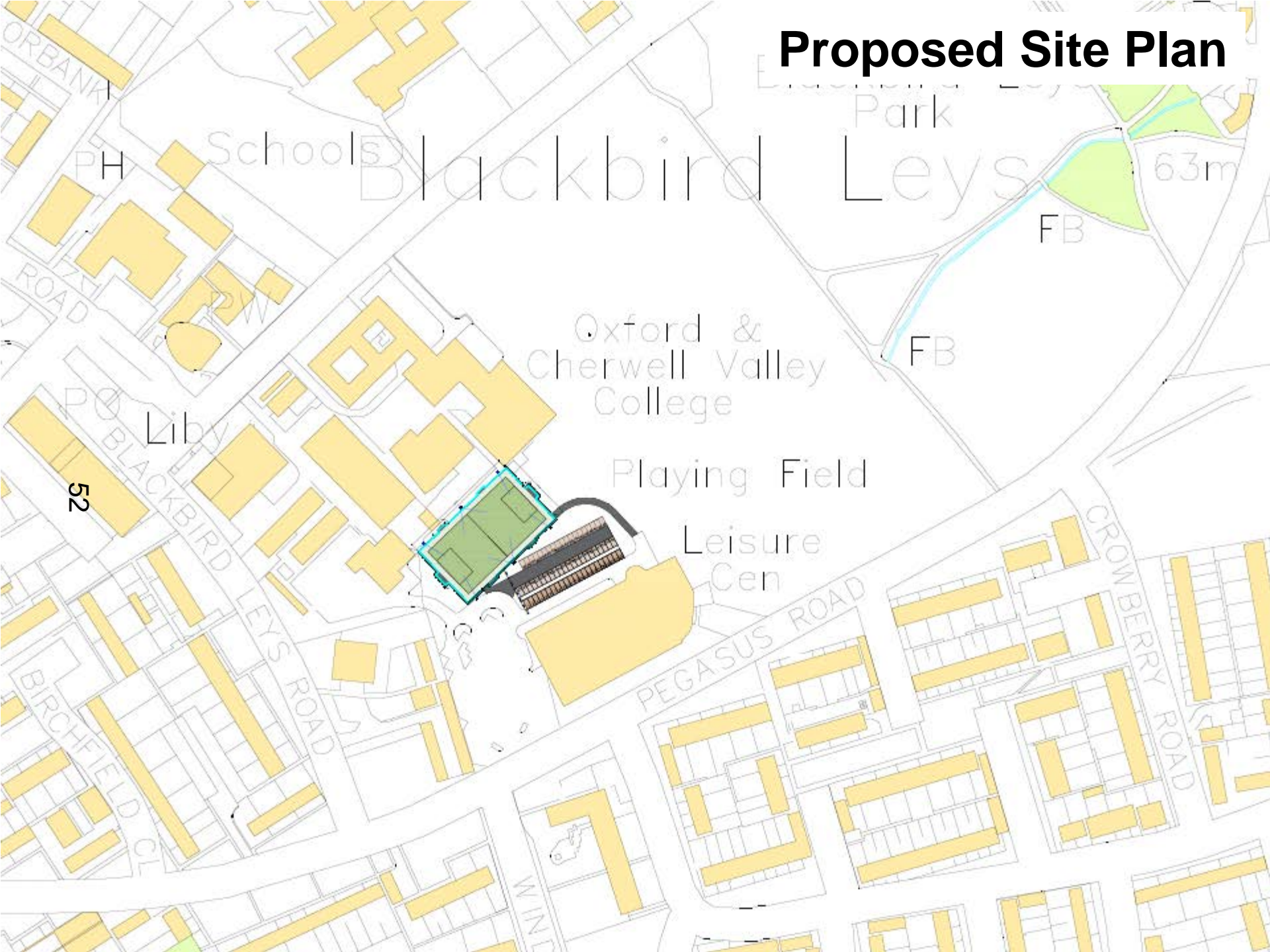

Blackbird Leys

Oxford & Cherwell Valley College

Playing Field

Leisure Cen

Park

63m

FB

FB

52

ORBANK

PH

Schools

Liby

ROAD

BLACKBIRD LEYS ROAD

BIRCHFIELD CT

PEGASUS ROAD

CROWBERRY ROAD

WIND

Proposed Site Plan

- 3G Artificial Grass Playing Area
- 3G Artificial Grass Run Off Area
- New Hard Standing Area
- New Porous BodPave Car Parking Bays
- Existing Porous BodPave Car Parking Bays
- 4.5m High Fence Line
- Replacement Floodlight Mast / Luminaire
- Paved Mowing Margin

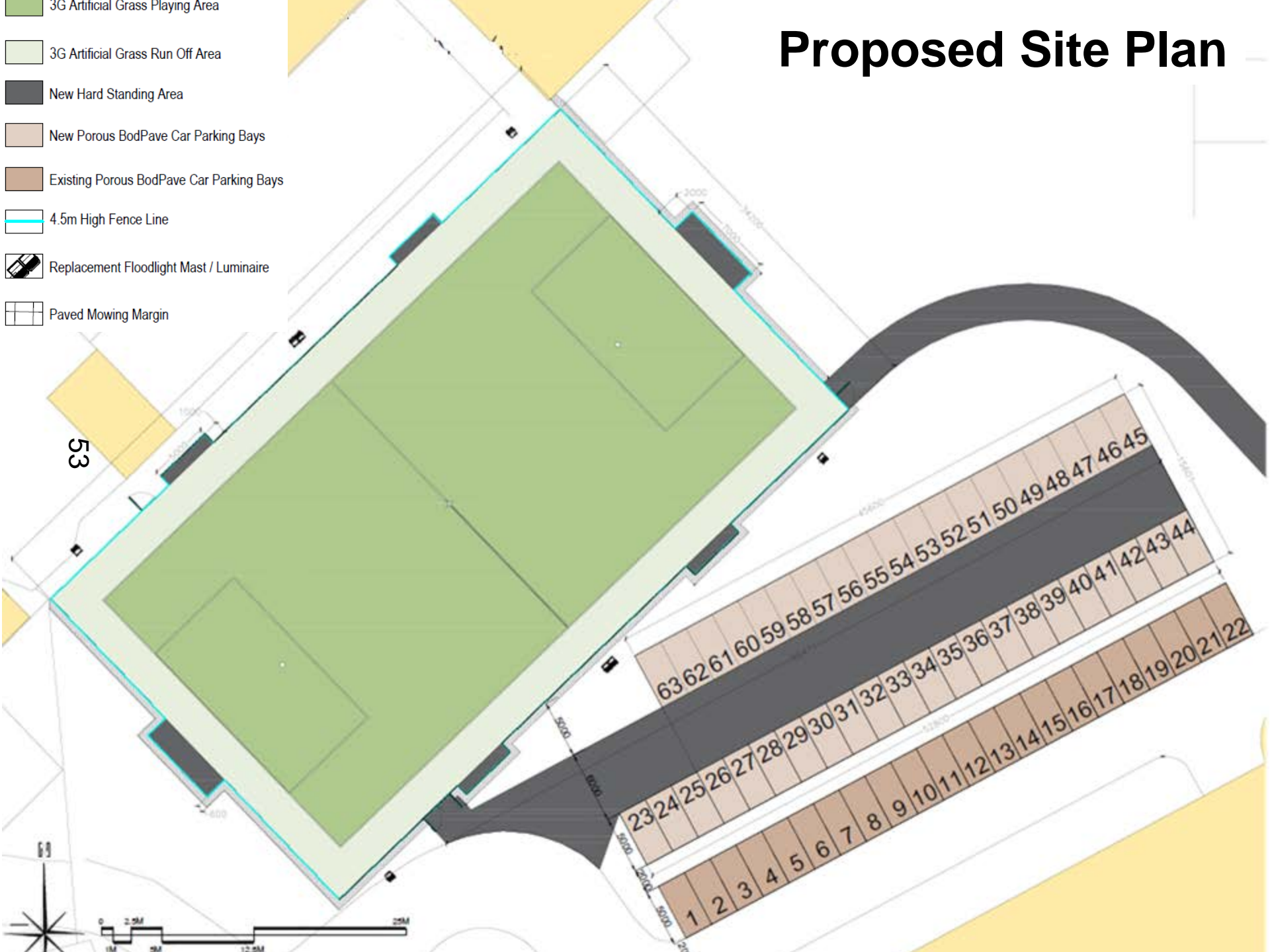

Proposed Elevations

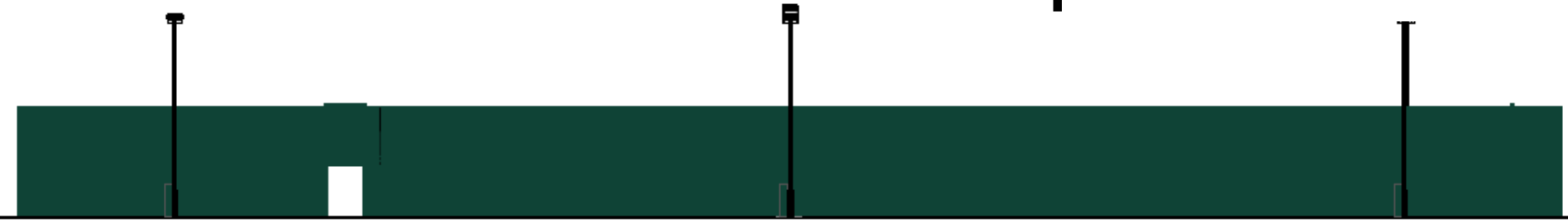

Elevation from South-East to North-West

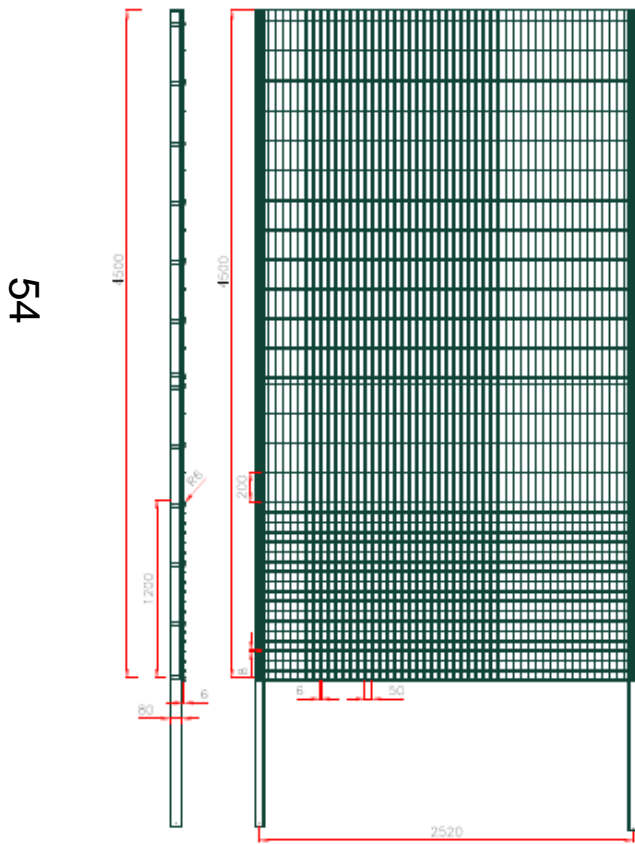

Fencing Section

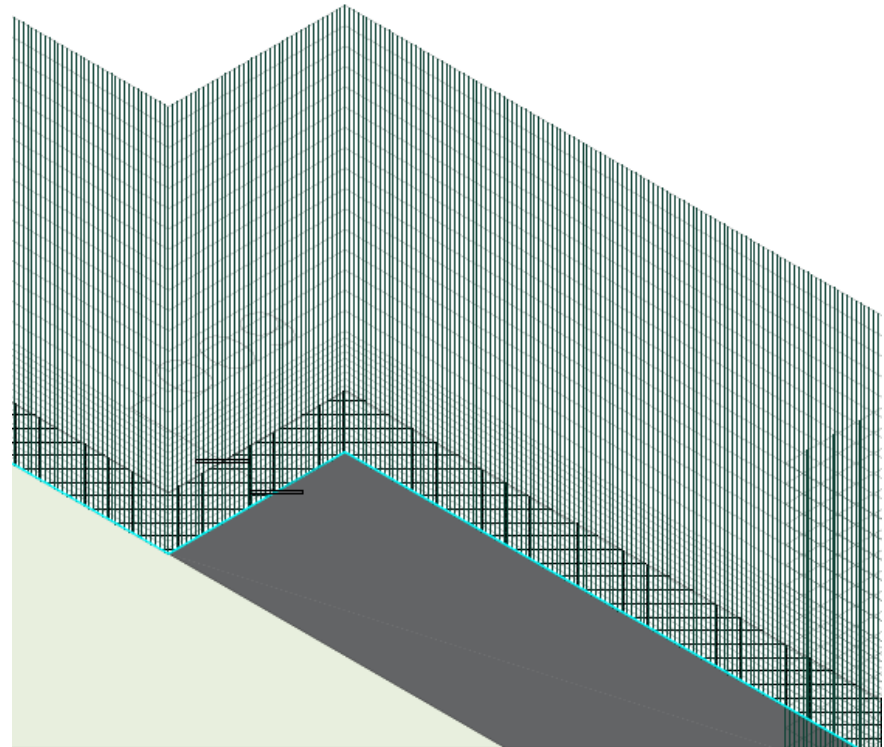

Fencing Elevation (Isometric)

Proposed Elevations (Isometric)

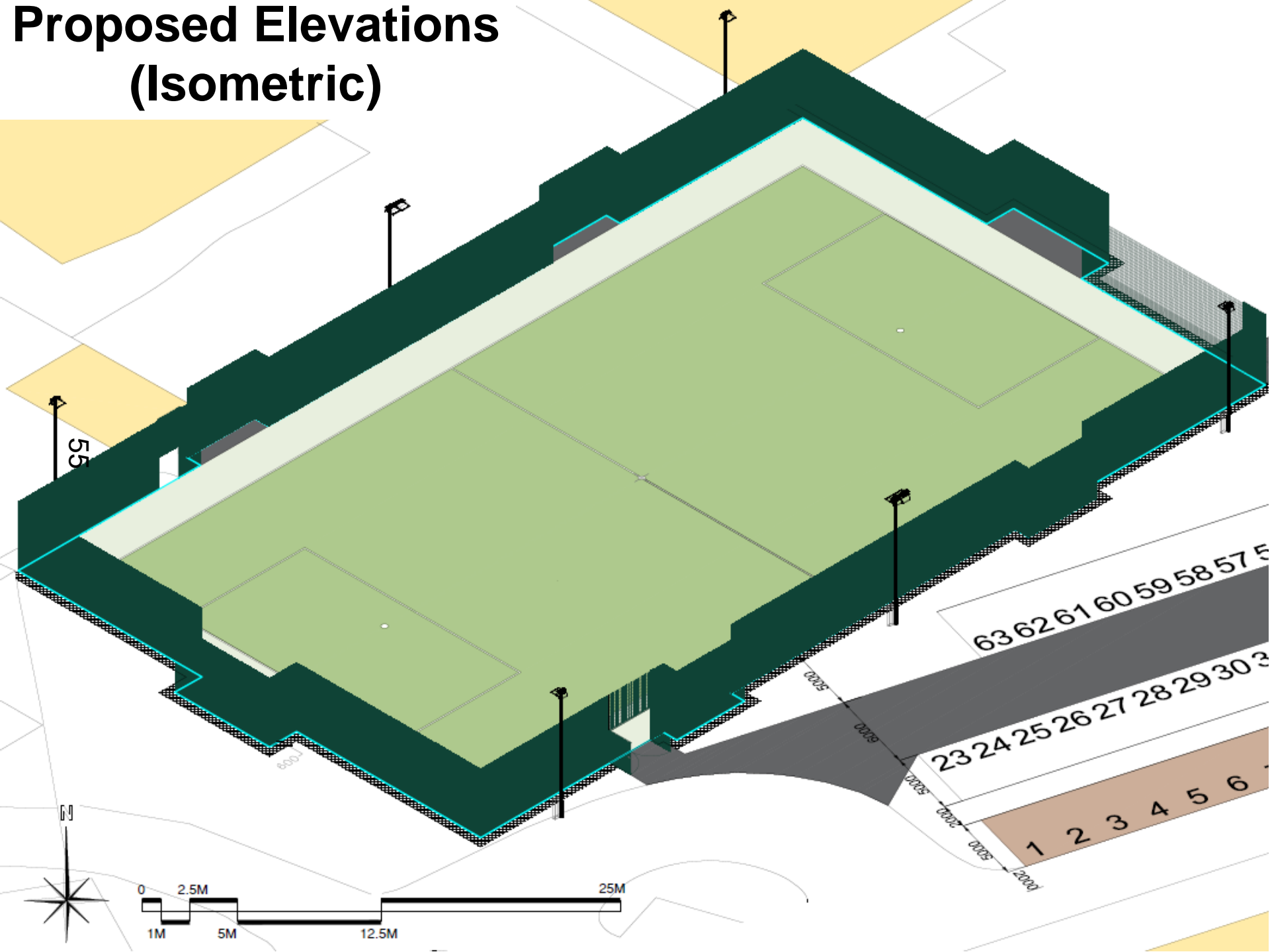

55

63 62 61 60 59 58 57 5

23 24 25 26 27 28 29 30 3

1 2 3 4 5 6

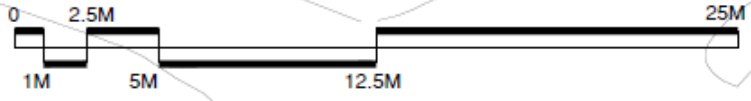

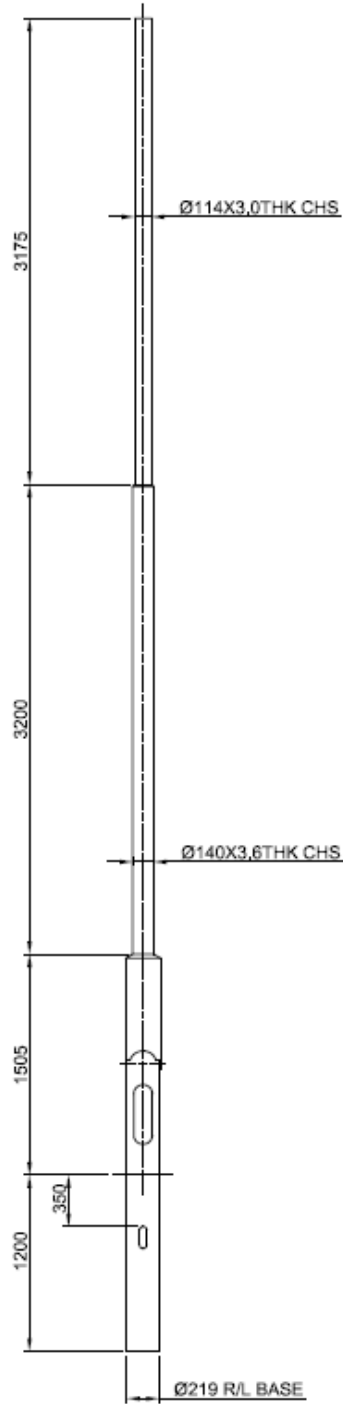

Proposed Elevations (Floodlighting Column)

Illumination Impact

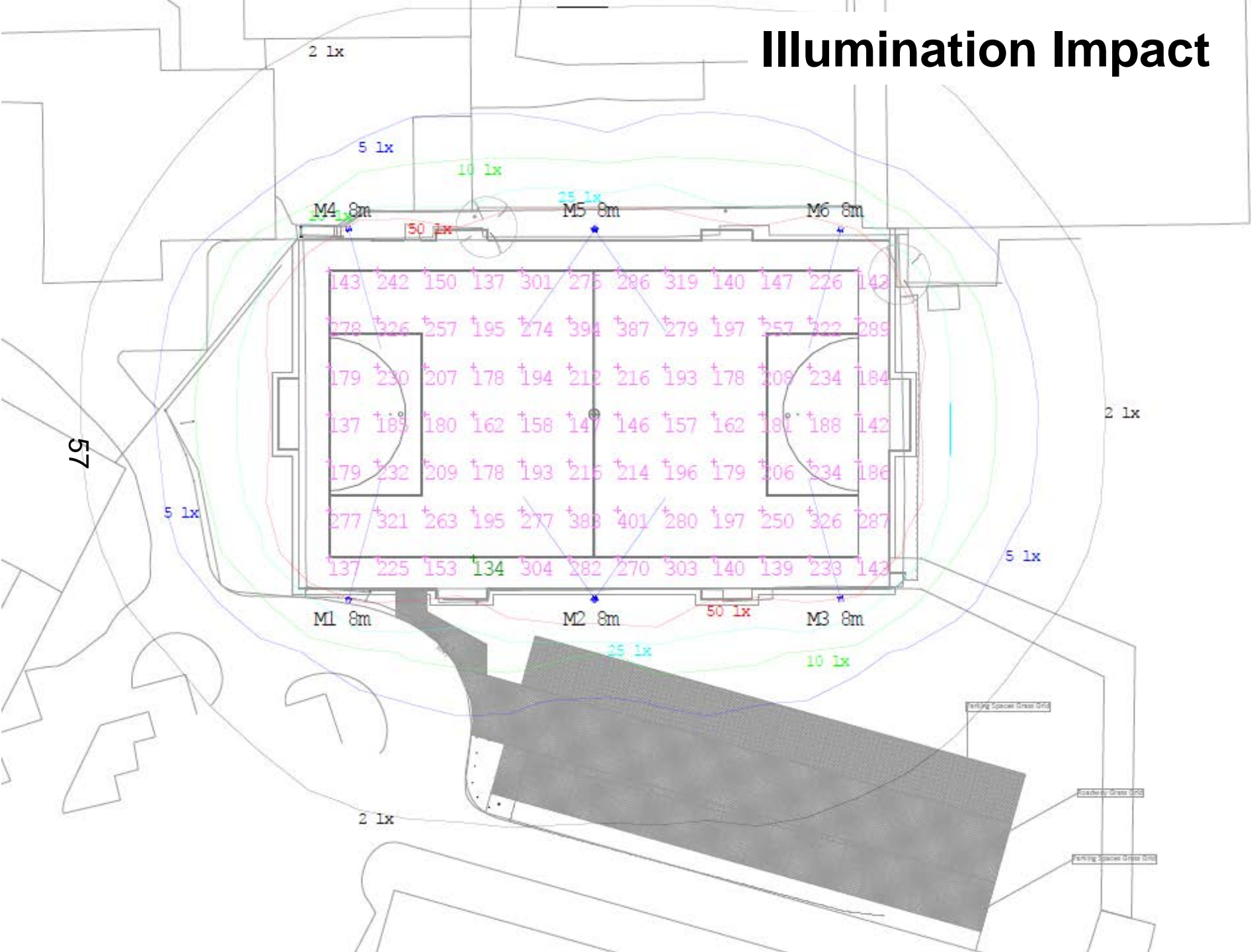

Proposed Materials



3G artificial grass



Ball stop fencing



Football application



Artificial (flood) luminaires



Typical 3G Artificial Grass Pitch (AGP) Installation



Overspill parking bays